

Wall Mounted Bucket Sink

- Seamless moulded bucket sink
- Supplied with 38mm (1.1/2") dia waste fitting, wall brackets, hinged grate and removable splashback
- Hygienic stainless steel 304 construction
- Material thickness 0.9mm
- Product code **VBSWM**

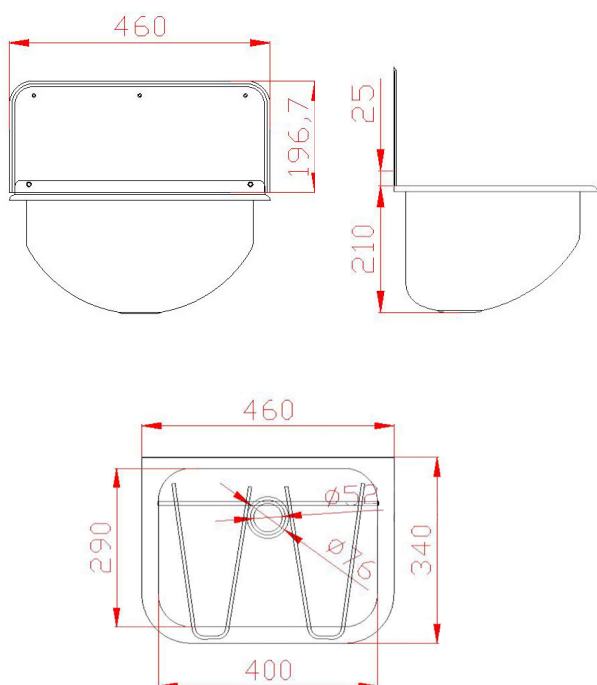

Optional Extra: CHN40 Bib Taps



Material	Stainless steel 304
Overall length (mm)	460
Overall width (mm)	340
Overall height (mm)	407
Bowl length (mm)	400
Bowl width (mm)	340
Bowl depth (mm)	210
Splashback height (mm)	197
Overflow	No
Tap ledge	No
Bowl finish	Descaled
Waste size (mm)	38 (1.1/2")
No of waste holes	1
Taps (optional extra)	Bib taps - CHN40